

# F06 Configuration and Accessories

Mold Injection Connector (IP68 Factory Assembly Only)

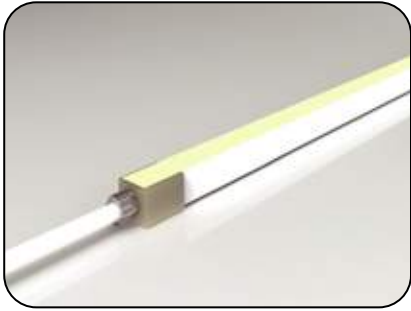

Direct Entry Connector  
 MJ-06-A-D01/02/03  
 MJ-06-A-D01SM  
 MJ-06-A-D02SF  
 MJ-06-A-D03SFM

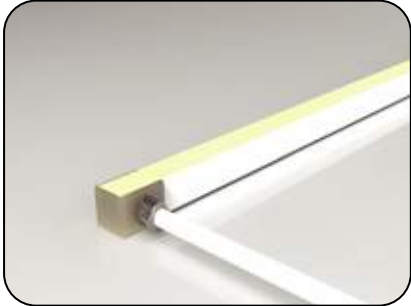
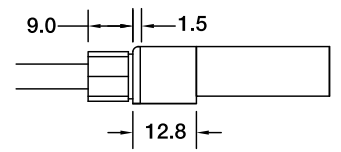
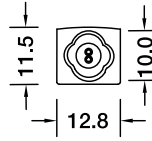

Side Entry Connector  
 MJ-06-A-S01/02/03  
 MJ-06-A-S01SM  
 MJ-06-A-S02SF  
 MJ-06-A-S03SFM

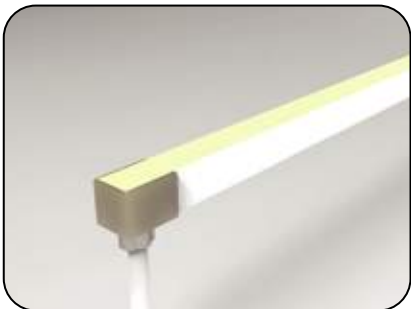
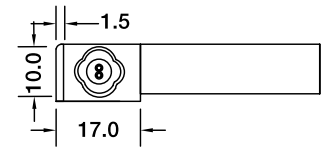
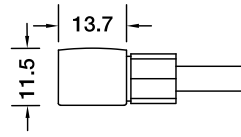

Bottom Entry Connector  
 MJ-06-A-B01/02/03  
 MJ-06-A-B01SM  
 MJ-06-A-B02SF  
 MJ-06-A-B03SFM

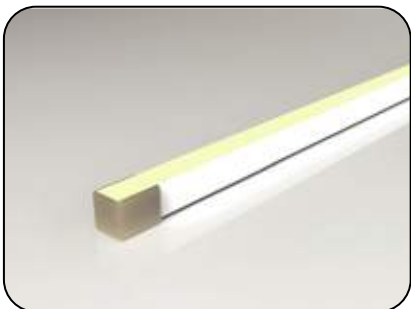
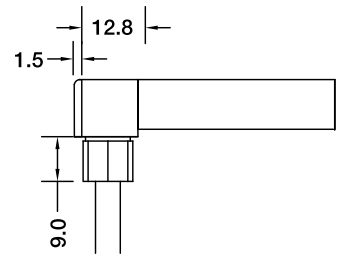
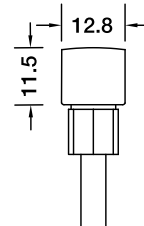

End Cap

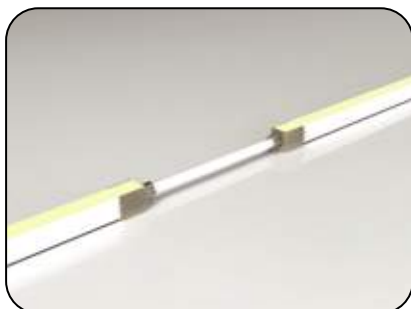
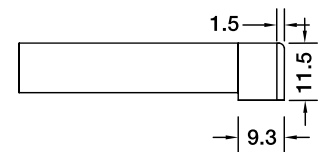
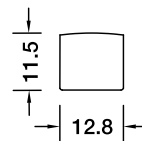

Jumper  
 MJ-06-A-D-JC

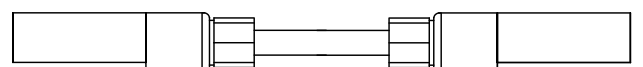

# F06 Configuration and Accessories



DIY Snap Connector  
DIY-SN-FR-06-D-01/02-A

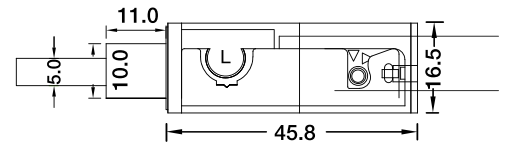
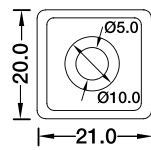

DIY Snap End Cap  
DIY-SN-END-06-D-01/02

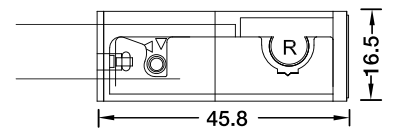
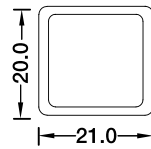

DIY Snap Connector Jumper  
DIY-SN-FR-06-A-D-JC



Waterproof Interrupter

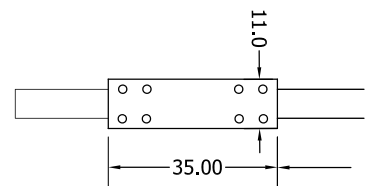

Male & Female Connector  
SYZ-M8-M-2C-05-W

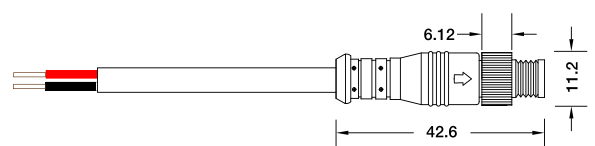

# F06 Configuration and Accessories

---



Male & Female Connector  
SYZ-M8-F-2C-05-W

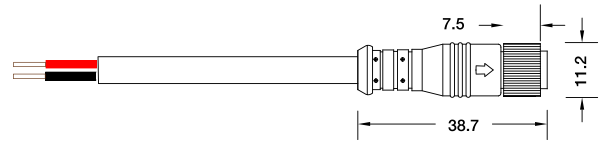

# LED linear Flex Mounting Channel

## 1. Aluminum Channel

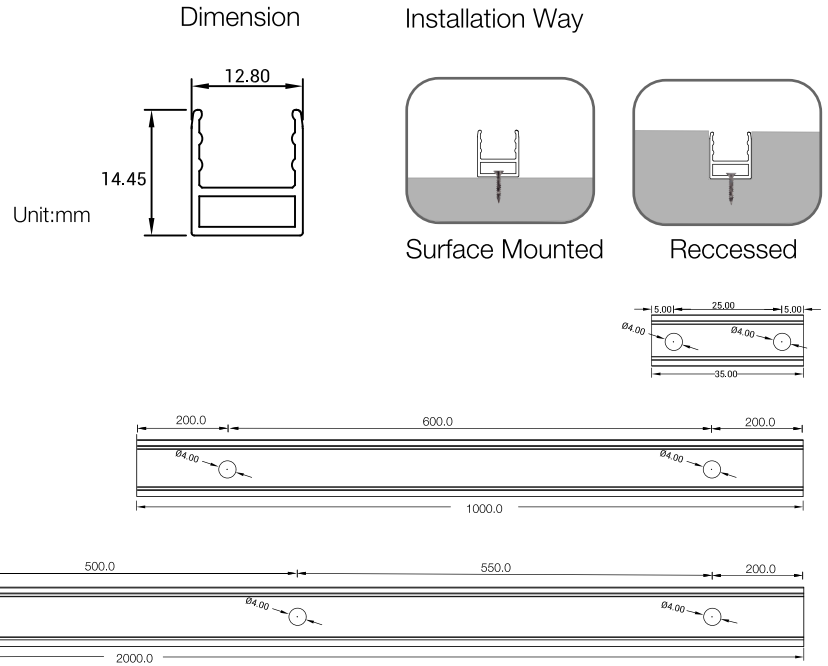

| Model        | W x H(mm)  | Standard Length | Screw Holes | Holes Numbers | Suitable Product |
|--------------|------------|-----------------|-------------|---------------|------------------|
| ALC08S01-035 | 12.8*14.45 | 35mm            | Ø4.0mm      | 2             | F06, SF06        |
| ALC08S01-100 |            | 1000mm          | Ø4.0mm      | 2             | F06, SF06        |
| ALC08S01-200 |            | 2000mm          | Ø4.0mm      | 4             | F06, SF06        |

## 2. Flexible Aluminum Channel

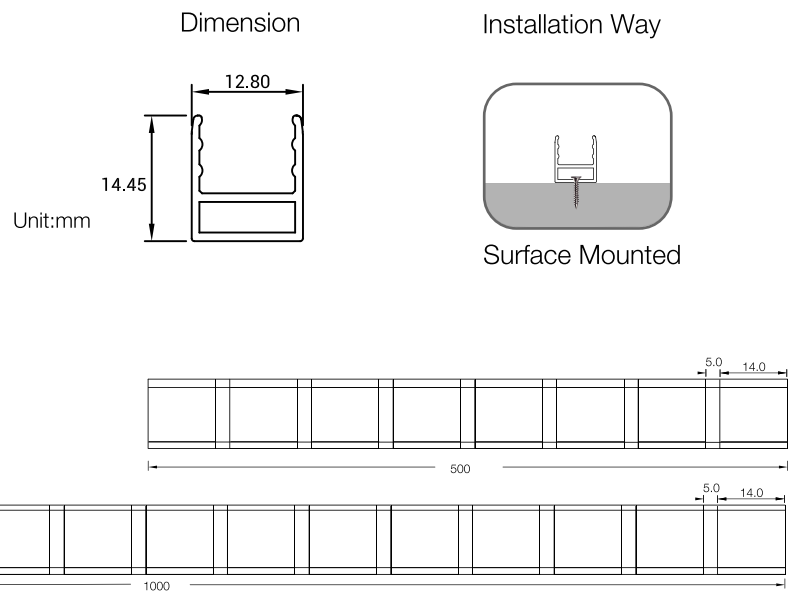

| Model          | W x H(mm)  | Standard Length | Suitable Product |
|----------------|------------|-----------------|------------------|
| ALC06S01FLX-10 | 12.8*14.45 | 500mm           | F06, SF06        |
| ALC06S01FLX-20 |            | 1000mm          | F06, SF06        |

# LED linear Flex Packing Details



Standard: Carton ( Paper Reel Inside)

| Product  | Max.Length | Carton Size | Net Weight | Gross Weight |
|----------|------------|-------------|------------|--------------|
| F15/SF15 | 30m        | 34*34*18cm  | 12kg       | 13.6kg       |
| F16/SF16 | 20m        | 34*34*18cm  | 8.6kg      | 10.2kg       |
| F17/SF17 | 20m        | 34*34*18cm  | 8.6kg      | 10.2kg       |
| F18/SF18 | 20m        | 34*34*18cm  | 8.6kg      | 10.2kg       |
| F21/SF21 | 20m        | 34*34*18cm  | 10.4kg     | 12.0kg       |
| F10/SF10 | 30m        | 34*34*18cm  | 9.6kg      | 11.2kg       |
| F09/SF09 | 35m        | 34*34*18cm  | 5.8kg      | 7.4kg        |
| F08/SF08 | 30m        | 34*34*18cm  | 7.2kg      | 8.8kg        |
| F06/SF06 | 30m        | 34*34*18cm  | 7.2kg      | 8.8kg        |



Custom: Carton ( White Box+ Plastic Plate Inside)

| Product  | Package 1 Dimension | Length | Gross Weight | Package 2 Dimension | Length | Gross Weight |
|----------|---------------------|--------|--------------|---------------------|--------|--------------|
| F15/SF15 | 38*38*3cm           | 5m     | 2.5kg        | 45*55*3cm           | 10m    | 5kg          |
| F16/SF16 | 38*38*3cm           | 5m     | 2.6kg        | 51*61*4cm           | 10m    | 5.2kg        |
| F17/SF17 | 38*38*3cm           | 5m     | 2.6kg        | 51*61*4cm           | 10m    | 5.2kg        |
| F18/SF18 | 38*38*3cm           | 5m     | 2.6kg        | 51*61*4cm           | 10m    | 5.2kg        |
| F21/SF21 | 38*38*3cm           | 5m     | 3.1kg        | 51*61*4cm           | 10m    | 6.2kg        |
| F10/SF10 | 38*38*3cm           | 5m     | 2.0kg        | 45*55*3cm           | 10m    | 4kg          |
| F09/SF09 | 38*38*3cm           | 5m     | 1.5kg        | 45*55*3cm           | 10m    | 3kg          |
| F08/SF08 | 38*38*3cm           | 5m     | 1.5kg        | 45*55*3cm           | 10m    | 3kg          |
| F06/SF06 | 38*38*3cm           | 5m     | 1.5kg        | 45*55*3cm           | 10m    | 3kg          |